

SERVICE PARTS LIST

GROUP:	15B
FORM:	8MR
FILE:	Alternator Parts List Section
DATE:	June, 2006

MODEL	VOLTS	AMPS
Various See Chart		

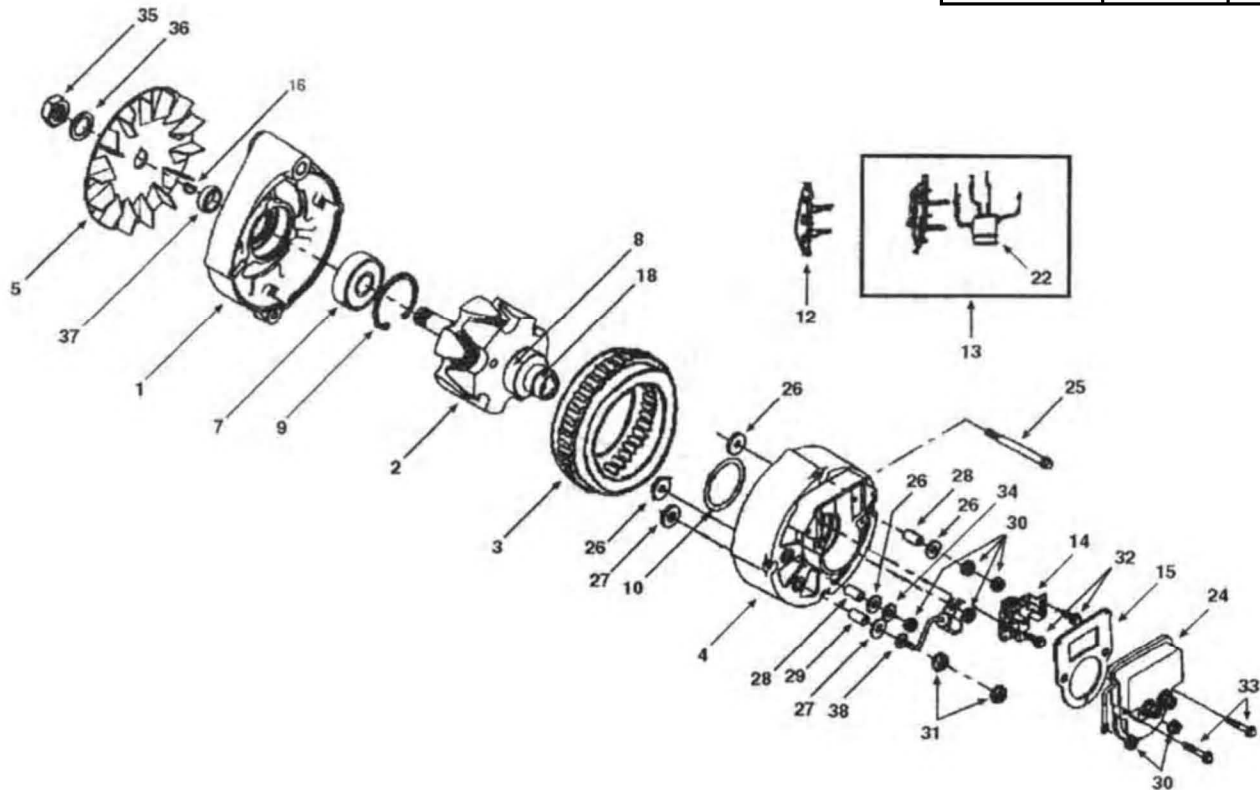

MODEL NO.	SALES NO.	1 HSNG FRONT	2 ROTOR ASSEM	3 STATOR ASSEM	4 HSNG REAR	5 FAN	6 PULLEY	7 BRNG FRONT	8 BRNG REAR	9 FR. BRNG RET	10 R. BRNG RET	11 DIODE ISOLAT.	12 DIODE REC.NEG.
8MR3005C	110-489	114-9	112-95	113-74	114-106	107-114		111-21	111-21	111-3	111-64		101-193
8MR3005CA	110-518	114-9	112-95	113-74	114-106	107-114		111-21	111-21	111-3	111-64		101-193
8MR3088KA		114-279	112-98	113-79	114-280	107-102		111-78	111-21	111-81	111-64		101-252
8MR3115KA	110-533	114-269	112-91	113-79	114-259	107-102		111-21	111-34	111-80	111-64		101-238
8MR3300G	110-465	114-278	112-99	113-70	114-106			111-21	111-78	111-81	111-64		101-238
8MR3301G	110-486	114-278	112-99	113-70	114-106	107-104		111-78	111-21	111-81	111-64		101-238
8MR3404G	110-684	114-9	112-34	113-70	114-106	107-114		111-21	111-21	111-3	111-64		101-193
8MR3405G	110-546	114-9	112-34	113-70	114-106	107-114		111-21	111-21	111-3	111-64		101-193

Important: The information contained in this bulletin is intended for use by trained, professional technicians who have the proper tools, equipment, and training to perform the required maintenance described above. This information is NOT intended for 'do-it-yourselfers', and you should not assume that this information applies to your equipment. If you have any questions regarding this information please visit our website at www.prestolite.com, or contact our technical service department at:

SERVICE PARTS LIST

GROUP:	15B
FORM:	8MR

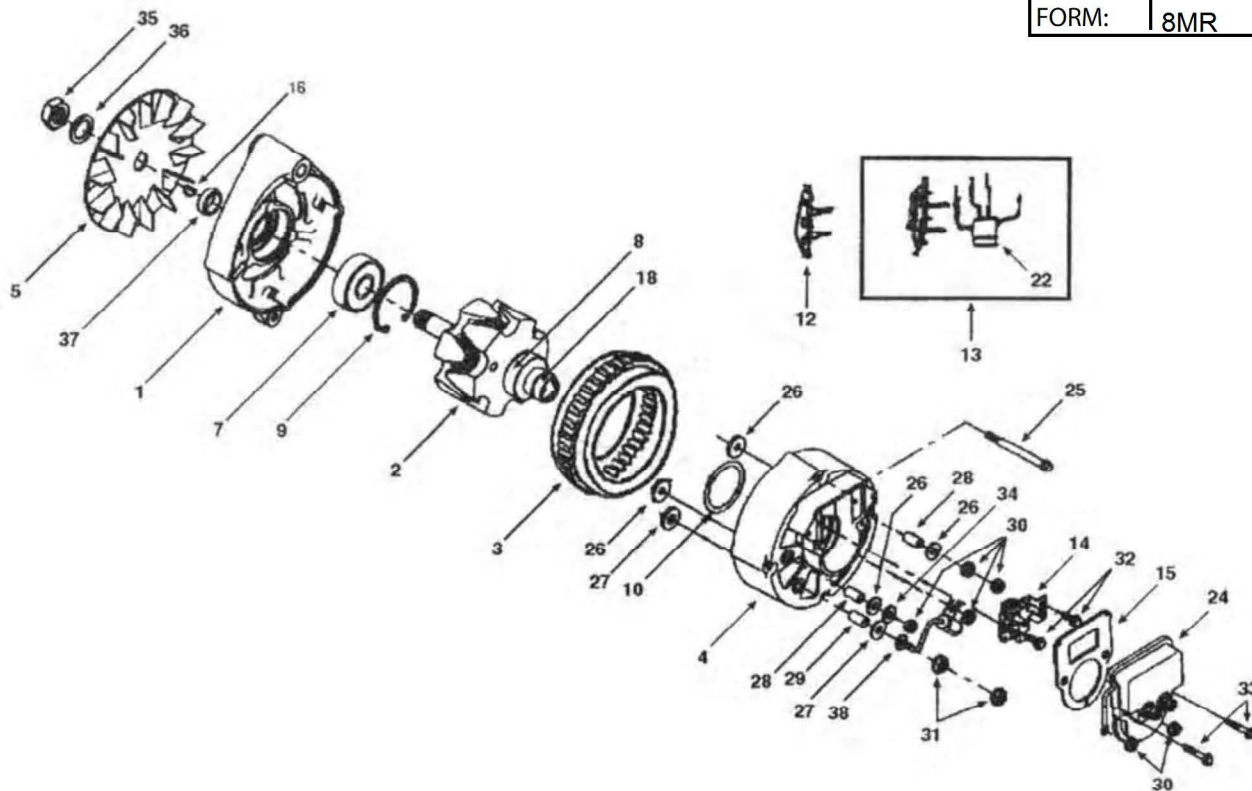

MODEL NO.	SALES NO.	13 DIODE RCT. POS.	14 BRUSH ASSEM.	15 GASKET	16 WDRFF KEY	17 COVER BRUSH HOLDER	18 SLIP RING ASSEM.	19 CABLE ASSEM. GRD	20 CABLE AC ASSEM.	21 AC TAP ASSEM.	22 DIODE TRIO	23 CABLE	24 VOLT. REG.
8MR3005C	110-489	101-235	103-46	103-14	120-7		112-22				101-130		105-311
8MR3005CA	110-518	101-235	103-46	103-14	120-7		112-22				101-130		105-311
8MR3088KA		101-251	103-46	103-56			112-22						105-318
8MR3115KA	110-533	101-237	103-46	103-50	120-241		112-22				101-228		105-311
8MR3300G	110-465	101-237	103-46	103-14			112-22				101-228		105-320
8MR3301G	110-486	101-237	103-46	103-14			112-22				101-228		105-328
8MR3404G	110-684	101-235	103-46	103-50	120-7		112-22				101-130		105-311
8MR3405G	110-546	101-235	103-46	103-14	120-7		112-22				101-130		105-328

Important: The information contained in this bulletin is intended for use by trained, professional technicians who have the proper tools, equipment, and training to perform the required maintenance described above. This information is NOT intended for 'do-it-yourselfers', and you should not assume that this information applies to your equipment. If you have any questions regarding this information please visit our website at www.prestolite.com, or contact our technical service department at:

KEY NO.	SALES NO.	DESCRIPTION	8MR3005C	8MR3005CA	8MR3008KA	8MR3115KA	8MR3300G	8MR3301G	8MR3404G	8MR3405G
		BOLTS								
25	120-86	THROUGH BOLT			4	4	4	4	4	4
25	120-1	THROUGH BOLT	4	4						
		INSULATORS								
26	115-51	WASHER, INSL. #10, .06TH	4	4	4	6	4	4	4	4
27	115-54	WASHER, INSL. 1/4, .06TH	2	2	4	2	2	2	2	2
28	115-27	INSULATOR, SLEEVE	2	2	2		2	2	2	
29	115-26	INSULATOR, SLEEVE	1	1	2		1	1	1	
		NUTS								
30	120-376	10-24, 1/8TK	9	9	4	2		5	5	
31	120-342	NUT, CON LOCK 1/4-20	2	2	6			2	2	
35	120-136	NUT, PULLEY	1	1				1	1	
35	120-292	NUT, PULLEY			1		1	1		
31	120-384	NUT, CONICAL, M6 x 1.0				2	2	2		
30	120-254	NUT, M5 x .8 1/8TK				7	6	10	2	
		SCREWS								
32	120-102	SCREW, TAPPING, 8-32 x .50	2	2	2	2	2	2	2	2
33	120-178	SCREW, TAPPING, 8-32 x .75	2	2		2		2	2	2
33	120-246	SCREW, TAPPING 8-32 x 1.75			4					
		WASHERS								
34	120-378	WASHER, FLAT .203 - .50	3	3	3	3	3	3	3	3
36	120-137	WASHER, SPLIT LOCK	1	1				1	1	
36	120-321	WASHER, SPLIT LOCK			1	1	1	1		
		MISC.								
38	120-40	CAPACITOR					1			
37	120-152	SPACER, FAN	1	1				1	1	
37	120-394	SPACER, FAN			1					
37	120-361	SPACER, FAN				1				

Phone/Fax: (866) 288-9853
webmail@prestolite.com